

ESSENTIALS PRE-TAN EXMITT

The exfoliating **Exmitt** is a convenient, fuss-free way to gently exfoliate the skin and balance pH levels prior to a sunless tan application. The elimination of dead skin cells along with the boost of amino acid levels, allows clients to maximize color results.

1 BUFF & BALANCE

- Immediately prior to a spray tan, client's should buff & balance the skin for great results.
- Quick way for clients to prep their skin to replenish moisturize and balance pH levels to assure the most natural tan.



2 MULTIPURPOSE DESIGN

- No water required.
- Infused with amino acid boosters that magnify sunless and UV color results
- Jump start the DHA reaction
- Remove residual sunless color between sessions

3 ONE MITT FOR EVERYONE

- First time tanners.
- Educated tanners who appreciate quality ingredients and expert performance.
- Gym-goers, ideal for those who can't shower before their spray session.
- Cocktail tanners.

Available size: Single/24 piece display
Norvell Item No: NXM1/NXM24
Fragrance: Raspberry Almond



Paraben Free · Gluten Free · Non-Comedogenic · Cruelty Free · Sulfate Free · 100% Vegan · Nut Allergy Free

HOW TO USE:

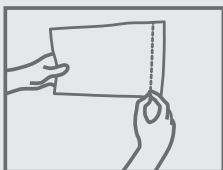

1. TEAR ALONG DOTTED LINE

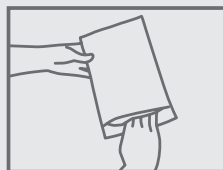

2. INSERT HAND INTO MITT

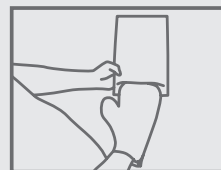

3. PULL PACKAGE OFF OF HAND



4. APPLY

PRODUCT INGREDIENTS: Aqua (Water/Eau), Ethoxydiglycol, Fragrance (Parfum), Polysorbate 20, Sodium Hyaluronate, Aloe Barbadensis Leaf Juice, Solanum Lycopersicum (Tomato) Fruit Extract, Vaccinium Macrocarpon (Cranberry) Fruit Extract, Sodium PCA, Ascorbic Acid (Vit. C), Tocopheryl Acetate (Vit. E), Propanediol, Xanthan Gum, Glycerin, Methyl Gluceth-20, Phenoxyethanol, Caprylyl Glycol, Citric Acid, Yellow 5/CI 19140, Blue 1/CI 42090, Coumarin